

# Pitot Tube

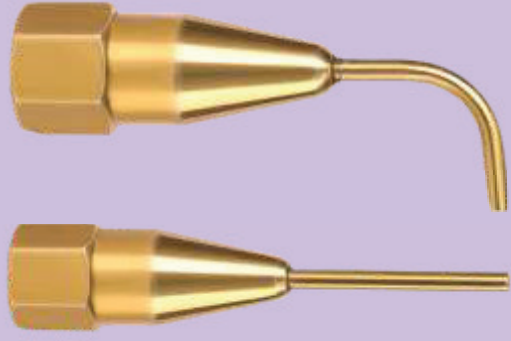

## Applications

- Solid brass pitot tube is ideal with pressure gauge to measure water pressure at discharge points to achieve a highly uniform irrigation system.

## Functions

- Utilize this small, effective and easy tool to measure the velocity of moving water.
- Attach a pitot tube to a pressure gauge.
- Hold the tip of the pitot tube into the sprinkler's stream. Hold it at a distance equal to half the diameter of the nozzle.
- Avoid inserting the tip of the pitot tube into the bore of the nozzle, as this will skew your measurements.
- A word of warning: Using the pitot tube can get wet and messy. Have a towel handy in case you get sprayed.

## Dimensions (in)

	1/4" S	1/4" B
W	15.87	15.87
L1	34	24
L	77	67
d	2	2
D	3	3

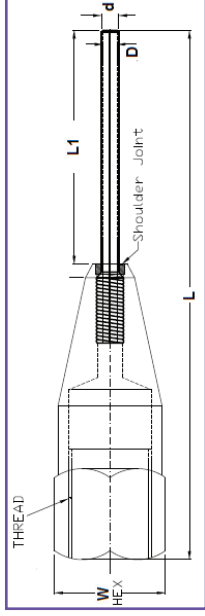

## Technical Specifications

- Available Sizes: 1/4" Female BSP/NPT Threaded
- Two Models Available: With Straight tube (S) / Bend tube (B)
- Max. Operating Pressure: 10 Bar/ 145 Psi
- Material: Brass
- Excellent for measuring pipeline pressures.
- Smooth flow with minimal pressure drop.

