

# Mini T Type Screen Filters

AQ-123T



AQ-124TM



Specifications	AQ-123T		AQ-124TM	
	US Standard	Metric Standard	US Standard	Metric Standard
Inlet/outlet connection	1 1/2" NPT male thread	1 1/2" BSP male thread	2" NPT male thread	2" BSP male thread
Maximum Operating Pressure	85Psi	6 kg/cm <sup>2</sup>	85Psi	6 kg/cm <sup>2</sup>
Range of Flow Rate	50 - 70 GPM	12 - 16 m <sup>3</sup> /h	80 - 95 GPM	18 - 22 m <sup>3</sup> /h
Nominal Flow Rate	65 GPM	15 m <sup>3</sup> /h	85 GPM	20 m <sup>3</sup> /h
Filtration Surface Area	46 in <sup>2</sup>	295 cm <sup>2</sup>	46 in <sup>2</sup>	295 cm <sup>2</sup>
Material of Construction	Reinforce Polypropylene		Reinforce Polypropylene	
Screen Material	Stainless Steel SS-316		Stainless Steel SS-316	
Cartridge Diameter	2.76 in	70mm	2.76 in	70 mm
Cartridge Length	8.82 in	224mm	8.82 in	224 mm
Available Mesh	80, 120, 150 mesh	80, 120, 150 mesh	80, 120, 150 mesh	80, 120, 150 mesh

Filtering Element

- 80 Mesh
- 120 Mesh
- 150 Mesh

Head Loss : AQ - 123T					
Flow m <sup>3</sup> /hr	10	14.4	15	18	20
Pressure Loss kg/cm <sup>2</sup>	0.06	0.16	0.20	0.34	0.42
Flow GPM	44	63.36	66	79.2	88
Pressure Loss PSI	0.85	2.27	2.84	4.83	5.96

Head Loss : AQ - 124 TM						
Flow m <sup>3</sup> /hr	15	18	20	22	25	26.4
Pressure Loss kg/cm <sup>2</sup>	0.20	0.34	0.42	0.48	0.60	0.64
Flow GPM	66	79.2	88	96.8	110	116.16
Pressure Loss PSI	2.84	4.83	5.96	6.82	8.52	9.09

# Mini T Type Screen Filters

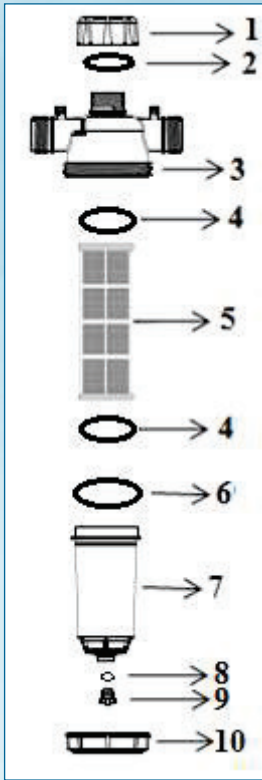

1 1/2" T type Screen Filter (Model 123 T - 15 m <sup>3</sup> /hr)				
AIPL CODE	DESCRIPTION	INLET/OUTLET	CONNECTION SIZE	MICRON /MESH
14140009	1 1/2" T type Scree Filter - 120 Mesh	Male Threaded NPT	1 1/2"	130/120
14000051	1 1/2" T-type Screen Filter - 120 Mesh	Male Threaded BSP	1 1/2"	130/120
SPARE PARTS				
S. NO	PARTS NAME	PART CODE	MATERIAL	QTY
1	End cap (1 1/2")	12530025	Glass Reinforced PP	1
2	End cap (1 1/2") O-ring	50010054	NBR	1
3	Filter Body BSP	12490230	Glass Reinforced PP	1
	Filter Body NPT	12490231		
4	Cartridge O-ring (1 1/2")	50010049	NBR	2
5	Cartridge - 120 mesh (1 1/2" FILTER)	12490064	Glass Reinforced PP	1
6	Barrel O-ring	50010128	NBR	1
7	Barrel	12490236	Glass Reinforced PP	1
8	End plug O-ring	50010067	NBR	1
9	1/2" End Plug	12490238	Glass Reinforced PP	1
10	Filter Ring	12490237	Glass Reinforced PP	1

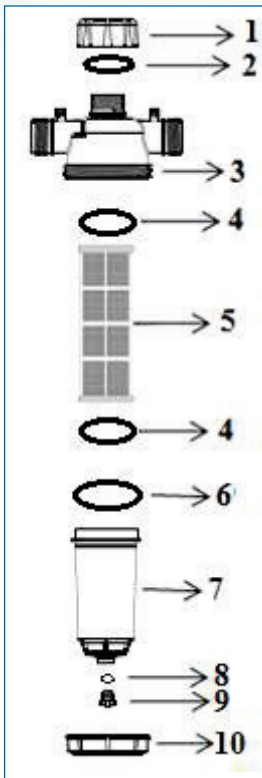

2" T-type Screen Filter (Model 124 TM - 20 m <sup>3</sup> /hr)				
AIPL CODE	DESCRIPTION	INLET/OUTLET	CONNECTION SIZE	MICRON /MESH
14140011	2" T-type Screen Filter - 120 Mesh	Male Threaded NPT	2"	130/120
14000052	2" T-type Screen Filter - 120 Mesh	Male Threaded BSP	2"	130/120
SPARE PARTS				
S. NO	PARTS NAME	PART CODE	MATERIAL	QTY
1	End Cap (2" BSP)	12490027	Glass Reinforced PP	1
2	End cap O-ring	50010043	NBR	1
3	Filter Body BSP	12490232	Glass Reinforced PP	1
	Filter Body NPT	12490233		
4	Cartridge O-ring (1 1/2")	50010049	NBR	2
5	Cartridge 120 mesh (1 1/2" FILTER)	12490064	Glass Reinforced PP	1
6	Barrel O-ring	50010128	NBR	1
7	Eco Filter Barrel	12490236	Glass Reinforced PP	1
8	End plug O-ring	50010067	NBR	1
9	1/2" End Plug	12490238	Glass Reinforced PP	1
10	Filter Ring	12490237	Glass Reinforced PP	1