

Y Type Screen Filters

AQ-124YS



AQ-124Y



Specifications	AQ-124YS		AQ-124Y	
	US Standard	Metric Standard	US Standard	Metric Standard
Inlet / outlet	2" NPT	2" BSP	2" NPT	2" BSP
Maximum Operating Pressure	110 PSI	8 Kg/cm ²	110 PSI	8 Kg/cm ²
Range of Flow Rate	80-95 GPM	18-22 m ³ /hr	80-120 GPM	18-27 m ³ /hr
Nominal Flow Rate	85 GPM	20m ³ /hr	110 GPM	25m ³ /hr
Filtration Surface Area	46 in ²	295cm ²	76 in ²	492cm ²
Material of Construction	Polypropylene Glass Reinforced		Polypropylene Glass Reinforced	
Filtering Cartridge	304/316 Grade Stainless Steel Screen		304/316 Grade Stainless Steel Screen	
Cartridge Diameter	2.7 Inches	69mm	4.3 Inches	109mm
Cartridge Length	8.7 Inches	222mm	11.3Inches	286mm
Available Mesh	80, 120, 150	80, 120, 150	80, 120, 150	80, 120, 150

Filtering Element

- 80 Mesh
- 120 Mesh
- 150 Mesh

	Flow Loss				
Flow m ³ /hr	14.4	18	20	22	26.4
Pressure Loss kg/cm ²	0.17	0.25	0.3	0.34	0.43
Flow GPM	63.0	75.0	85.0	95.0	116.0
Pressure Loss PSI	2.36	3.25	3.93	4.68	6.05

	Flow Loss					
Flow m ³ /hr	12	15	18	25	27	32.4
Pressure Loss kg/cm ²	0.03	0.07	0.1	0.2	0.24	0.34
Flow GPM	53.0	66.0	80.0	110.0	120.0	142.0
Pressure Loss PSI	0.43	0.99	1.47	2.84	3.29	4.73

Y Type Screen Filters

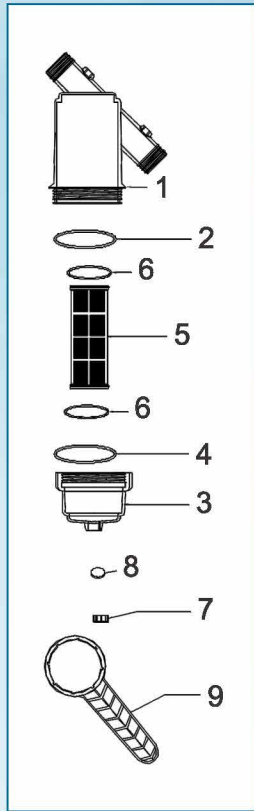

2" Screen Filter (Model 124 YS - 20 m ³ /hr)				
AIPL CODE	DESCRIPTION	INLET/OUTLET	CONNECTION SIZE	MICRON /MESH
14310004	2" Screen Filter Y - Type 120 Mesh	Male Thread NPT	2"	130/120
14040005	2" Screen Filter Y - Type 120 Mesh	Male Thread BSP	2"	130/120
SPARE PARTS				
S. NO	PARTS NAME	PART CODE	MATERIAL	QTY
1	Body (BSP Thread) Without Hole	12490061	Glass reinforced PP	1
	Body (NPT Thread) Without Hole	12490062		
2	Body O-Ring	50010050	NBR	1
3	Cap	12490063	Glass reinforced PP	1
4	Cap Gasket	50030025	NBR	1
5	Screen Cartridge (80 Mesh) Black	12490066	Glass reinforced PP	1
	Screen Cartridge (120 Mesh) Blue	12490064		
	Screen Cartridge (150 Mesh) Red	12490065		
6	Cartridge O-Ring	50010082	NBR	1
7	3/4" End Cap	12490057	PA	1
8	End Cap Washer	50020003	NBR	1
9	Spanner (Key)	12490114	Glass reinforced PP	1

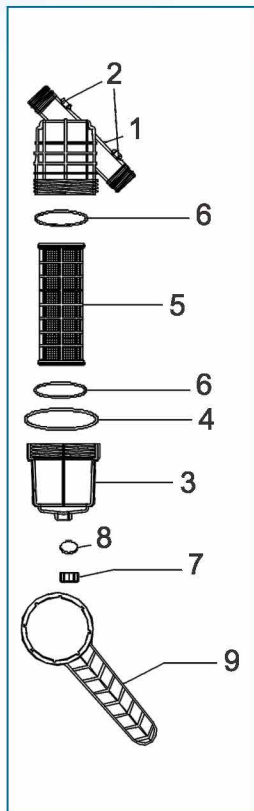

2" Screen Filter (Model 124 Y - 25 m ³ /hr)				
AIPL CODE	DESCRIPTION	INLET/OUTLET	CONNECTION SIZE	MICRON /MESH
14310005	2" Screen Filter Y Type 120 Mesh	Male Thread NPT	2"	130/120
14040004	2" Screen Filter Y Type 120 Mesh	Male Thread BSP	2"	130/120
SPARE PARTS				
S. NO	PARTS NAME	PART CODE	MATERIAL	QTY
1	Body (BSP Thead) Without Hole	12490052	Glass reinforced PP	1
	Body (NPT Thead) Without Hole	12490053		
2	Body O-ring	50100033	Brass	2
3	Cap	12490055	Glass reinforced PP	1
4	Cap Gasket	50030008	NBR	1
5	Screen Cartridge (80 Mesh) Black	12490031	Glass reinforced PP	1
	Screen Cartridge (120 Mesh) Blue	12490029		
	Screen Cartridge (150 Mesh) Red	12490032		
6	Cartridge O-Ring	50010086	NBR	2
7	3/4" End Cap	12490057	PA	1
8	End Cap Washer	50020003	NBR	1
9	Spanner (Key)	50100014	Glass reinforced PP	1